

# imageRUNNER ADVANCE 4500 III series

## TRUSTED MULTIFUNCTIONAL, WITH VERSATILE END-TO-END DOCUMENT CAPABILITIES



Canon uniFLOW Online  
Outstanding Cloud Output Management Solution



Canon imageRUNNER ADVANCE 4535i  
Outstanding 35-ppm Copier MFP



### MAIN CONFIGURATION OPTIONS

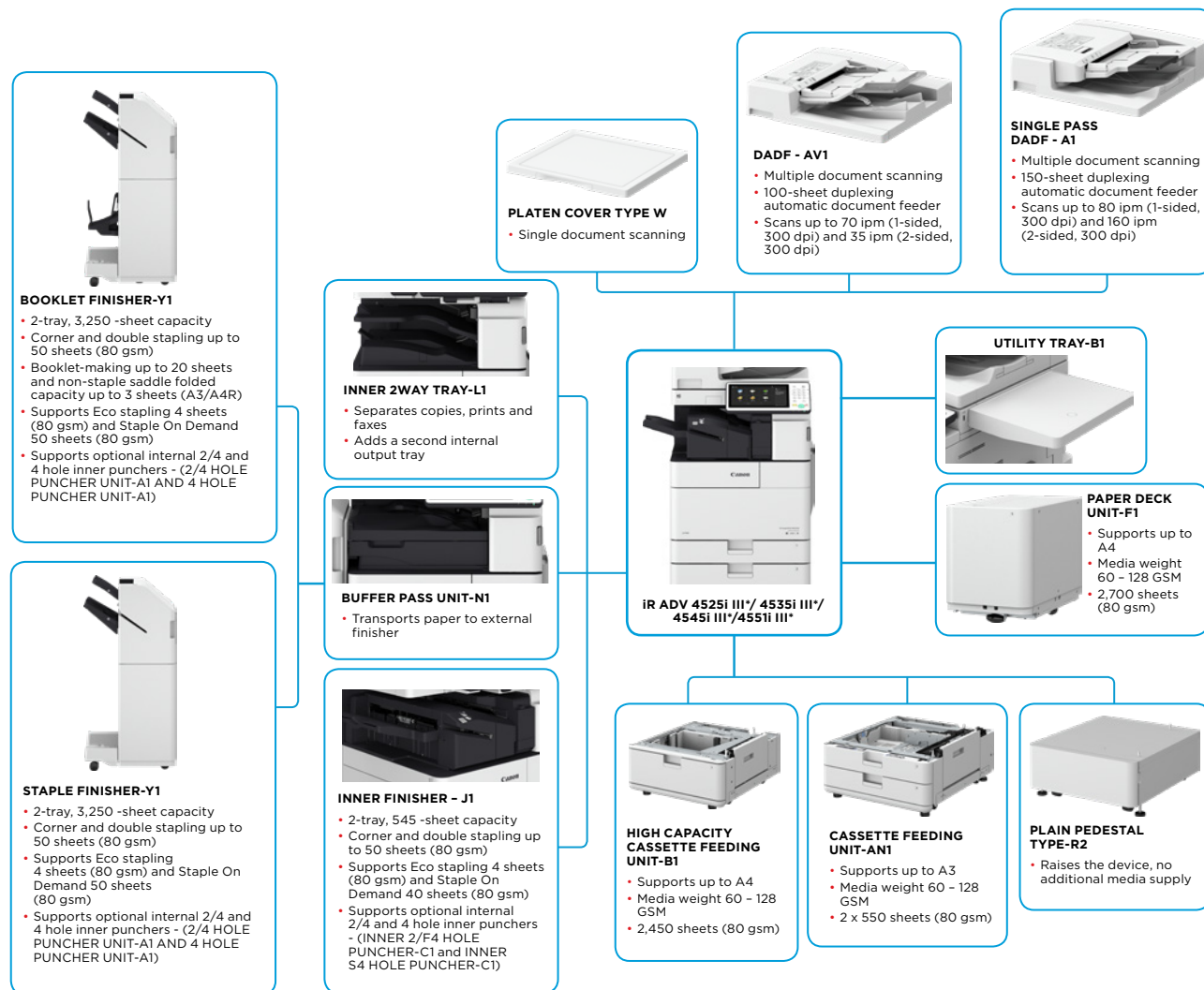

This flat configuration is for illustration purpose only. For a complete list of options and the exact compatibility relationships, please refer to the online product configurator.

III\* indicates that this model has been upgraded to new system software and includes additional security features as standard.

# TECHNICAL SPECIFICATIONS

# imageRUNNER ADVANCE 4500 III series

## MAIN UNIT

<b>Machine type</b>	A3 Monochrome Laser Multifunctional
<b>Core functions</b>	Print, Copy, Scan, Send, Store and Optional Fax
<b>Processor</b>	Canon Dual Custom Processor (Shared)
<b>Control Panel</b>	Standard: 25.6 cm (10.1 inch) TFT LCD WSVGA Colour Touch panel
<b>Memory</b>	Standard: 3.0GB RAM
<b>Hard Disk drive</b>	Standard: 250GB, Maximum: 1TB
<b>Mirroring Hard Disk Drive</b>	Optional: 250GTB, 1TB
<b>Interface Connection</b>	NETWORK Standard: 1000Base-T/100Base-TX/10Base-T, Wireless LAN (IEEE 802.11 b/g/n) Optional: NFC, Bluetooth Low Energy OTHERS Standard: USB 2.0 (Host) x2, USB 3.0 (Host) x1, USB 2.0 (Device) x1; Optional: Serial Interface, Copy Control Interface
<b>Paper Supply Capacity (A4, 80gsm)</b>	Standard: 1,200 sheets 550-sheet cassette x 2, Multi-purpose tray : 100 sheets (TBD) Maximum: 6,350 sheets (with High Capacity Cassette Feeding Unit-Bland Paper Deck Unit-F1)
<b>Paper output capacity (A4, 80gsm)</b>	Standard: 250 Sheets Maximum: 3,350 Sheets (with Buffer Pass-N1 + Staple Finisher-Y1 or Booklet Finisher-Y1)
<b>Finishing capabilities</b>	Standard: Collate, Group With Inner Finisher : Collate, Group, Offset, Staple, Hole Punch <sup>1</sup> , Staple-Free Staple, Staple On Demand With External Finisher <sup>2</sup> : Collate, Group, Offset, Staple, Saddle Stitch <sup>3</sup> , Hole Punch <sup>4</sup> , Staple-Free Staple, Staple On Demand <sup>1</sup> Requires Inner 2/F4 Hole Puncher-C1 or Inner S4 Hole Puncher-C1 <sup>2</sup> Requires Buffer Pass-N1 <sup>3</sup> Requires Booklet Finisher-Y1 <sup>4</sup> Requires 2/4 Hole Puncher Unit-A1 or 4 Hole Puncher Unit-A1
<b>Supported media types</b>	Paper Cassette (1/2): Thin, Plain, Thick, Colour, Recycled, Pre-punched  Multi-purpose tray: Thin, Plain, Thick, Colour, Recycled, Pre-punched, Tranceparency, Tracing <sup>*</sup> , Label, Bond, Envelope <sup>*</sup> Some types of tracing paper cannot be used.
<b>Supported media sizes</b>	Upper Cassette 1: Standard size: A4, A4R, A5R, B4, B5, B5R Custom size: Min. 139.7 x 182.0 mm up to 297.0 x 390.0 mm  Lower Cassette 2: Standard size: A3, A4, A4R, A5R, B4, B5, B5R Custom size: Min. 139.7 x 182.0 mm up to 297.0 x 431.8 mm  Multi-purpose tray: Standard size: A3, A4, A4R, A5, A5R, A6R, B4, B5, B5R, Envelopes [No. 10(COM 10), Monarch, ISO-C5, DL] Custom Size: Min. 98.0 x 148.0 mm to 297.0 x 431.8 mm Free Size: Min. 98.0 x 148.0 mm to 297.0 x 431.8 mm
<b>Supported media weights</b>	Paper Cassettes (1/2): 60 to 128 gsm Multi-purpose tray: 52 to 220 gsm (Thin: vertical grain paper feed only: 52 to 59gsm) Duplex: 60 to 105 gsm
<b>Warm-up Time</b>	From Power On: 24 Seconds or Less <sup>*</sup> <sup>*</sup> Time from device power-on, until copy ready (not print reservation) From Sleep Mode: 10 Seconds or Less Quick Startup Mode: 4 seconds or less <sup>*</sup> <sup>*</sup> Time from device power-on to when key operations can be performed on the touch panel display.
<b>Dimensions (W x D x H)</b>	With platen cover: 587 x 728 x 822 mm With Single Pass DADF-A1: 587 x 740 x 945 mm With DADF-AV1: 587 x 750 x 926 mm
<b>Installation Space(W x D)</b>	Basic: 889 x 1,160 mm (with Platen Cover Type W + + Multi-purpose tray open/extension tray extended + Paper Cassette open) 889 x 1,172 mm (with Single Pass DADF-A1 + Multi-purpose tray open/extension tray extended + Paper Cassette open) 889 x 1,182 mm (with DADF-AV1 + Multi-purpose tray open/extension tray extended + Paper Cassette open)  Fully Configured: 1,811 x 1,270 mm (with Single Pass DADF-A1 + Paper Deck Unit-F1 + Booklet Finisher-Y1 with Saddle unit drawn +Paper Cassette open) 1,811 x 1,280 mm (with DADF-AV1 + Paper Deck Unit F1 + Booklet Finisher-Y1with Saddle unit drawn +Paper Cassette open)
<b>Weight</b>	With Platen Cover Type W: Approx. 73 kg including toner With Single Pass DADF-A1: Approx. 86 kg including toner With DADF-AV1: Approx. 81 kg including toner

## PRINT SPECIFICATIONS

<b>Print Speed (BW)</b>	iR-ADV 4551i III: 51 ppm (A4), 25 ppm (A3), 37 ppm (A4R), 20 ppm (A5R) iR-ADV 4545i III: 45 ppm (A4), 22 ppm (A3), 32 ppm (A4R), 20 ppm (A5R) iR-ADV 4535i III: 35 ppm (A4), 22 ppm (A3), 32 ppm (A4R), 20 ppm (A5R) iR-ADV 4525i III: 25 ppm (A4), 15 ppm (A3), 17 ppm (A4R), 17 ppm (A5R) 1,200 x 1,200
<b>Print Resolution (dpi)</b>	Standard: UFR II, PCL 6 Optional: Genuine Adobe PostScript Level 3
<b>Page description languages</b>	Standard: UFR II, PCL 6 Optional: Genuine Adobe PostScript Level 3
<b>Direct Print</b>	Direct printing available from USB memory, Advanced space, Remote UI and Web Access <sup>*</sup> Supported file types: TIFF, JPEG, PDF, EPS, and XPS <sup>*</sup> Only PDF print from websites is supported
<b>Printing from mobile and cloud</b>	AirPrint, Mopria, Google Cloud Print, and Canon PRINT Business, and uniFLOW Online A range of software and MEAP-based solutions are available to provide printing from mobile devices or internet-connected devices and cloud-based services depending on your requirements. Please contact your sales representative for further information
<b>Fonts</b>	PCL fonts: 93 Roman, 10 Bitmap fonts, 2 OCR fonts, Andale Mono WT J/K/S/T <sup>1</sup> (Japanese, Korean, Simplified and Traditional Chinese), Barcode fonts <sup>2</sup> PS fonts: 136 Roman <sup>1</sup> Requires optional PCL International Font Set-A1 <sup>2</sup> Requires optional Barcode Printing Kit-D1
<b>Print Features</b>	Suspend Job Timeout, Profile Settings, Secured Print, Watermark, Header/Footer, Page Layout, Two-sided Printing, Collating, Booklet Printing, Grouping, Mixed Paper Sizes/ Orientations, Offsetting, Front/Back Covers, Toner Reduction, Poster Printing, Forced Hold Printing
<b>Operating System</b>	UFR II: Windows 7 / 8.1 / 10 / Server 2008 / Server 2008 R2 / Server 2012 / Server 2012 R2 / Server 2016, MAC OS X (10.7 or later) PCL: Windows 7 / 8.1 / 10 / Server 2008 / Server 2008 R2 / Server 2012 / Server 2012 R2 / Server 2016 PS: Windows 7 / 8.1 / 10 / Server 2008 / Server 2008 R2 / Server 2012 / Server 2012 R2 / Server 2016, MAC OS X (10.7 or later) PPD: MAC OS X (10.7 or later), Windows 7 / 8.1 / 10  SAP Device Types are available via the SAP Market Place. Please refer to <a href="http://www.canon-europe.com/support/business-product-support">http://www.canon-europe.com/support/business-product-support</a> for availability of print solutions for other operating systems and environments including AS/400, UNIX, Linux and Citrix. Some of these solutions are chargeable.
<b>COPY SPECIFICATIONS</b>	
<b>Copy Speed</b>	iR-ADV 4551i III: 51 ppm (A4), 25 ppm (A3), 37 ppm (A4R), 20 ppm (A5R) iR-ADV 4545i III: 45 ppm (A4), 22 ppm (A3), 32 ppm (A4R), 20 ppm (A5R) iR-ADV 4535i III: 35 ppm (A4), 22 ppm (A3), 32 ppm (A4R), 20 ppm (A5R) iR-ADV 4525i III: 25 ppm (A4), 15 ppm (A3), 17 ppm (A4R), 17 ppm (A5R)
<b>First-Copy-Out Time (A4)</b>	iR-ADV 4551i III: Approx. 3.7 seconds or less iR-ADV 4545i III/4535i III: Approx. 3.8 seconds or less iR-ADV 4525i III: Approx. 5.2 seconds or less
<b>Copy resolution (dpi)</b>	Reading: 600 x 600 Printing: Up to 1,200 x 1,200
<b>Multiple Copies</b>	Up to 9,999 copies
<b>Copy Density</b>	Automatic or Manual (9 Levels)
<b>Magnification</b>	25% - 400% (1% Increments)
<b>Preset Reductions</b>	25%, 50%, 70%
<b>Preset Enlargements</b>	141%, 200%, 400%
<b>Basic Copy Features</b>	Preset R/E Ratios by Area, Paper Setting, Previous Setting, Favourite Setting, Finishing, Two-Sided, Density Adjustment, Original Type Selection, Interrupt Mode, Setting Confirmation/Cancel
<b>Special Copy Features</b>	Book to Two Pages, Two-sided Original, Finishing, Booklet, Job Build, N on 1, Add Cover, Insert Sheets, Different Size Originals, Density Adjustment, Original Type Selection, Transparency Cover Sheets, Page Numbering, Copy Set Numbering, Sharpness, Erase Frame, Secure Watermark, Print Date, Shift, Gutter, Print & Check, Negative/Positive, Repeat Images, Merge Job Blocks, Job Done Notice, Mirror Image, Store in Mail Box, Superimpose Image, Cascade Copy, Copy ID Card, Skip Blank Pages, Detect Feeder Multi Sheet Feed, Free Size Original



# TECHNICAL SPECIFICATIONS

# imageRUNNER ADVANCE 4500 III series

## SCAN SPECIFICATIONS

<b>Selectable type</b>	Single-pass Duplexing Automatic Document Feeder* (DADF-A1) or Duplexing Automatic Document Feeder (DADF-AV1) [2-sided to 2-sided (Automatic with DADF)] *Detect Feeder Multi Sheet Feed is supported.
<b>Document Feeder Paper Capacity (80 gsm)</b>	SINGLE PASS DADF-A1: 150 Sheets DADF-AV1: 100 Sheets
<b>Acceptable Originals and weights</b>	Platen: Sheet, Book, 3-Dimensional Objects (Height: Up to 50 mm, Weight: up to 2kg) Document Feeder media weight : SINGLE PASS DADF-A1: 1-sided scanning: 38 to 157 gsm (BW), 64 to 157 gsm (CL) 2-sided scanning: 50 to 157 gsm (BW), 64 to 157 gsm (CL) DADF-AV1: 1-sided scanning: 38 to 128 gsm (BW), 64 to 128 gsm (CL) 2-sided scanning: 50 to 128 gsm (BW), 64 to 128 gsm (CL)
<b>Supported media sizes</b>	Platen: max. scanning size: 297.0 x 431.8 mm Document Feeder media size: Single Pass DADF-A1: A3, A4, A4R, A5, A5R, B4, B5, B5R, B6R, Custom size: 128.0 x 139.7 mm to 304.8 x 431.8 mm DADF-AV1: A3, A4, A4R, A5, A5R, B4, B5, B5R, B6, Custom size: 139.7 x 128 mm to 297.0 x 431.8 mm
<b>Scan Speed (ipm: BW/CL; A4)</b>	SINGLE PASS DADF-A1: 1-sided Scanning: 80 /80 (300pi), 80 (BW: 600 dpi) 2-sided Scanning: 160 /160 (300pi), 150 (BW: 600 dpi) DADF-AV1: 1-sided Scanning: 70 /70 (300pi), 51 (BW: 600 dpi) 2-sided Scanning: 35 /35 (300pi), 25.5 (BW: 600 dpi)
<b>Scan Resolution (dpi)</b>	600 x 600, 400 x 400, 300 x 300, 200 x 400, 200 x 200, 200 x 100, 150 x 150, 100 x 100
<b>Pull Scan Specifications</b>	Colour Network ScanGear2. For both TWAIN and WIA Supported OS: Windows 7/8.1/10 Windows Server 2008/Server 2008 R2/Server 2012/Server 2012 R2/Server 2016
<b>Scan Method</b>	Send functionality available on all models Scan to USB Memory Key: Available on all models Scan to Mobile Devices and cloud-based services: A range of solutions is available to provide scanning to mobile devices or cloud-based services depending on your requirements. Please contact your sales representative for further information. TWAIN/WIA Pull scanning available on all models
<b>SEND SPECIFICATIONS</b>	
<b>Destination</b>	E-mail/Internet FAX (SMTP), SMB v3.0, FTP, WebDAV, Mail Box, Super G3 FAX (Optional), IP Fax (Optional)
<b>Address Book</b>	LDAP (2,000)/Local (1,600)/Speed dial (200)
<b>Send resolution (dpi)</b>	600 x 600, 400 x 400, 300 x 300, 200 x 400, 200 x 200, 200 x 100, 150 x 150, 100 x 100
<b>Communication protocol</b>	File: FTP (TCP/IP), SMB v3.0, WebDAV E-mail/f-Fax: SMTP, POP3
<b>File Format</b>	Standard: TIFF, JPEG, PDF (Compact, Searchable, Apply policy, Optimize for Web, PDF A/1-b, Encrypted), XPS (Compact, Searchable), Office Open XML (PowerPoint, Word), PDF/XPS(Device Signature) Optional: PDF (Trace & Smooth), PDF/XPS(User Signature)
<b>Universal Send Features</b>	Original Type Selection, Two-sided Original, Book to Two Pages, Different-size Originals, Density Adjustment, Sharpness, Copy Ratio, Erase Frame, Job Build, Sender's Name (TTI), Delayed Send, Preview, Job Done Notice, File Name, Subject/Message, Reply-to, E-mail Priority, TX Report, Original Content Orientation, Skip Blank Pages, Detect Feeder Multi Sheet Feed
<b>FAX SPECIFICATIONS</b>	
<b>Optional/ standard</b>	Optional on all models
<b>Maximum Number of Connection Lines</b>	2
<b>Modem Speed</b>	Super G3: 33.6 kbps G3: 14.4 kbps
<b>Compression Method</b>	MH, MR, MMR, JBIG
<b>Resolution (dpi)</b>	400 x 400, 200 x 400, 200 x 200, 200 x 100
<b>Sending/Recording Size</b>	A3, A4, A4R, A5*, A5R*, B4, B5*, B5R* <sup>1</sup> *Sent as A4 *Sent as B4
<b>FAX memory</b>	Up to 30,000 pages
<b>Speed dials</b>	Max. 200
<b>Group dials/destinations</b>	Max. 199 dials
<b>Sequential broadcast</b>	Max. 256 addresses
<b>Memory backup</b>	Yes
<b>Fax Features</b>	Original Type Selection, Two-sided Original, Book to Two Pages, Different-size Originals, Density (for Scanning), Sharpness, Copy Ratio, Erase Frame, Job Build, Sender's Name (TTI), Selecting the Telephone Line, Direct Send, Delayed Send, Preview, Job Done Notice, TX Report, Detect Feeder Multi Sheet Feed

## STORE SPECIFICATIONS

<b>Mail Box (Number supported)</b>	100 User Inboxes, 1 Memory RX Inbox, 50 Confidential Fax Inboxes 30,000 Maximum Pages Stored
<b>Advanced Space</b>	Communication Protocol: SMB or WebDAV Supported Client PC: Windows (Windows 7/8.1/10) Concurrent Connections (Max.): SMB: 64, WebDAV: 3 (Active Sessions)
<b>Advanced Space available disc space</b>	Approx. 16GB (Standard HDD) Approx. 480GB (with option 1TB HDD)
<b>Advanced Space Features</b>	Authentication for Advanced Space Log-in, Sort Function, Printing a PDF File with a Password, imageWARE Secure Audit Manager Support
<b>Memory Media</b>	Standard: USB Memory

## SECURITY SPECIFICATIONS

<b>Authentication</b>	Standard: Universal Login Manager (Device and Function Level Log-in), uniFLOW Online Express*, User Authentication, Department ID Authentication, Access Management System Optional: My Print Anywhere secure print (Requires uniFLOW) *No charge for this solution; however activation is required.
<b>Data</b>	<b>Standard:</b> Trusted Platform Module (TPM), Hard Disk Password Lock, Hard Disk Drive Erase, Mail Box Password Protection, Hard Disk Drive Encryption(FIPS140-2 Validated), Common Criteria Certification (DIN ISO 15408) <b>Optional:</b> Hard Disk Drive Mirroring, Hard Disk Drive removal, Data Loss Prevention (Requires uniFLOW)
<b>Network</b>	<b>Standard:</b> IP/Mac Address Filtering, IPSEC, TLS Encrypted Communication, SNMP v3.0, IEEE 802.1X, IPv6, SMTP Authentication, POP Authentication before SMTP, S/MIME
<b>Document</b>	<b>Standard:</b> Secure Print, Adobe LiveCycle® Rights Management ES2.5 Integration, Encrypted PDF, Encrypted Secure Print, Device signature, Secure Watermarks <b>Optional:</b> User signature, Document Scan lock

## ENVIRONMENTAL SPECIFICATIONS

<b>Operating Environment</b>	Temperature: 10 to 30 °C Humidity: 20 to 80 % RH (Relative Humidity)
<b>Power source</b>	iR-ADV 4551i: 220-240 V (±10 %), 50/60 Hz (±2 Hz), 5.6 Amp iR-ADV 4545i/4535i: 220-240 V (±10 %), 50/60 Hz (±2 Hz), 5.2 Amp iR-ADV 4525i: 220-240 V (±10 %), 50/60 Hz (±2 Hz), 4.3 Amp
<b>Plug (Main Unit)</b>	
<b>Power consumption</b>	Maximum: Approx. 1,500 W Printing: iR-ADV 4551i III: 882 W* <sup>1</sup> , iR-ADV 4545i III: 862 W* <sup>1</sup> , iR-ADV 4535i III: 783 W* <sup>1</sup> , iR-ADV 4525i III: 614 W* <sup>1</sup> Standby: Approx. 37 W* <sup>2</sup> Sleep mode: Approx. 0.9 W* <sup>2</sup> Plugin Off: Approx. 0.3W* <sup>3</sup> * <sup>1</sup> Reference value: measured one unit * <sup>2</sup> 0.9W sleep mode may not be possible in all circumstances due to certain settings. * <sup>3</sup> Reference value, Quick startup mode OFF
<b>Noise levels (BW/CL)</b>	Sound Power Level (LwAd) Active(BW): iR-ADV 4551i III: 73.8 dB or Less* <sup>1</sup> , iR-ADV 4545i III: 73.1 dB or Less* <sup>1</sup> , iR-ADV 4535i III: 71.8 dB or Less* <sup>1</sup> , iR-ADV 4525i III: 70.2 dB or Less* <sup>1</sup> , Standby: iR-ADV 4551i III: 37 dB* <sup>2</sup> , iR-ADV 4545i III: 37 dB* <sup>2</sup> , iR-ADV 4535i III: 36 dB* <sup>2</sup> , iR-ADV 4525i III: 36 dB* <sup>2</sup> Sound Pressure (LpAm) Bystander's position: Active(BW) (1-sided/2-sided): iR-ADV 4551i III: 54 dB/56 dB* <sup>2</sup> iR-ADV 4545i III: 51 dB/56 dB* <sup>2</sup> iR-ADV 4535i III: 51 dB/54 dB* <sup>2</sup> iR-ADV 4525i III: 50 dB/52 dB* <sup>2</sup> Standby: iR-ADV 4551i III/4545i III: 21 dB* <sup>2</sup> iR-ADV 4535i III/4525i III: 20 dB* <sup>2</sup> * <sup>1</sup> DE-U2205 (2017) compliant (Data taken from Blue Angel Standard value) * <sup>2</sup> Reference value: Measured only one unit with ISO7779, described with ISO9296 (1988)
<b>Standards</b>	Blue Angel

## CONSUMABLES

<b>Toner Cartridge/s</b>	C-EXV 53 TONER BK
<b>Toner (Estimated Yield @6% Coverage)</b>	C-EXV 53 TONER BK: 42,100 pages

## SOFTWARE AND PRINTER MANAGEMENT

<b>Tracking and reporting</b>	Universal Login Manager* (ULM): Manage your costs easily by using the embedded reporting capability to identify and control costs on a user-based level by device. uniFLOW Online Express: Combining with ULM you can gain further control and highlight expenditures per users/department and pinpoint where costs can be scaled down from a central cloud based location. *Installation, activation & registration required
-------------------------------	--



# TECHNICAL SPECIFICATIONS

# imageRUNNER ADVANCE 4500 III series

<p><b>Remote management tools</b></p>	<p><b>iW Management Console:</b> Server-based software for centralised management of a fleet of devices (includes monitoring or consumables, status monitoring and alerts, distribution of address books, configuration settings, firmware and MEAP applications, meter capture and reporting, driver and resource management) <b>eMaintenance:</b> Compatible with eMaintenance services via embedded RDS (Enables meter capture, automatic consumables management, remote diagnostics and reporting for service providers to offer efficient, fast and proactive maintenance) <b>Content Delivery System:</b> Allows the Remote distribution of firmware, iR options and MEAP applications; Remote User Interface (RUI) Web based interface to each device that helps to provide remote device management and control</p>	<p><b>STAPLE FINISHER-Y1 (External)</b></p>	<p>(Requires Buffer Pass-N1) Number of Trays: 2 Upper Tray Capacity*: A4, A5, A5R, A6R, B5: 250 sheets, A3, A4R, B4, B5R: 125 sheets, Lower Tray Capacity*: A4, A5, A5R, B5: 3,000 sheets, A3, A4R B4, B5R: 1,500 sheets, A6R: 250 sheets (52 to 105 gsm), 50 sheets (106 to 220 gsm) *with 81.4 gsm paper Paper Weight: 52 to 220 gsm Staple Position: Corner, Double Staple Capacity: Corner and Double Stapling: A4/B5: 50 sheets (52 to 90 gsm) A3/A4R/B4: 30 sheets (52 to 90 gsm) Eco Staple: A3/A4: 5 sheets (52 to 64 gsm) 4 sheets (65 to 81.4 gsm) 3 sheets (81.5 to 105 gsm) Staple On Demand: 50 sheets (90 gsm) Dimensions (W x D x H): 637 x 623 x 1,142 mm (when the extension tray is extended) Weight: Approx. 31 kg</p>
<p><b>Scanning software</b></p>	<p><b>Network ScanGear:</b> TWAIN-compliant scanner driver that enables computers on a network to use the pull scan functionality of the device</p>	<p><b>BOOKLET FINISHER-Y1 (External)</b></p>	<p>(Requires Buffer Pass-N1) (Includes the above STAPLE FINISHER-Y1 basic staple specifications.) Saddle Stitch paper size: A3, A4R, B4, Custom Size (195.0 x 270.0 mm to 297.0 x 431.8 mm) Saddle Stitch Staple Capacity: 20 sheets x 10 sets (60 to 81.4 gsm) (including 1 cover sheet up to 220 gsm) Non Staple Folded Bunch Capacity: up to 3 sheets (52 to 105 gsm) Dimensions (W x D x H): 637 mm x 623 mm x 1,142 mm (when the extension tray is extended) Weight: Approx. 57 kg</p>
<p><b>PAPER SUPPLY OPTIONS</b> <b>CASSETTE FEEDING UNIT-AN1</b></p>	<p>Paper Capacity: 550 sheets x 2 (80 gsm) Paper Type: Thin, Plain, Thick, Colour, Recycled, Pre-punched Paper Size: A3, A4, A4R, A5R, B4, B5R, B5, Custom size: 139.7 x 182.0 mm to 297.0 x 431.8 mm Paper Weight: 60 to 128 gsm Power Source: From the Main Unit Dimensions (W x D x H): 565 x 650 x 248 mm Weight: Approx. 23.5 kg</p>	<p><b>INNER 2/F4 HOLE PUNCHER-C1</b></p>	<p>(Requires the INNER FINISHER-J1) Two or Four Holes Acceptable Punch Paper Weight: 52 to 220 gsm Acceptable Punch Paper Size: Two holes A3, A4, A4R, B4, B5, B5R Four holes A3, A4 Power Source: From the Main Unit</p>
<p><b>HIGH CAPACITY CASSETTE FEEDING UNIT-B1</b></p>	<p>Paper Capacity: 2,450 sheets (80 gsm) Paper Type: Thin, Plain, Thick, Colour, Recycled, Pre-punched Paper Size: A4 Paper Weight: 60 to 128 gsm Power Source: From the Main Unit Dimensions (W x D x H): 565 x 650 x 248 mm Weight: Approx. 28 kg</p>	<p><b>INNER S4 HOLE PUNCHER-C1</b></p>	<p>(Requires the INNER FINISHER-J1) Four Holes Acceptable Punch Paper Weight: 52 to 220 gsm Acceptable Punch Paper Size: Four holes A3, A4, A4R, B4, B5, B5R Power Source: From the Main Unit</p>
<p><b>PAPER DECK UNIT-F1</b></p>	<p>Paper Capacity: 2,700 sheets (80 gsm) Paper Type: Thin, Plain, Thick, Colour, Recycled, Pre-punched Paper Size: A4, B5 Paper Weight: 60 to 128 gsm Power Source: From the Main Unit Dimensions (W x D x H): 344 x 630 x 440 mm Weight: Approx. 31 kg</p>	<p><b>2/4 HOLE PUNCHER UNIT-A1</b></p>	<p>(Requires either the STAPLE FINISHER-Y1 or BOOKLET FINISHER-Y1) Two or Four Holes Acceptable Punch Paper Weight: 52 to 220 gsm Acceptable Punch Paper Size: Two holes A3, A4, A4R, A5, B4, B5, B5R Four holes A3, A4 Power Source: From the Main Unit</p>
<p><b>OUTPUT OPTIONS</b> <b>INNER 2WAY TRAY-L1</b></p>	<p>Allows the separation of copies, prints and faxes. Adds a second internal output tray to give a combined output capacity of 350 sheets (upper tray 100 sheets/lower tray 250 sheets).</p>	<p><b>4 HOLE PUNCHER UNIT-A1</b></p>	<p>(Requires either the STAPLE FINISHER-Y1 or BOOKLET FINISHER-Y1) Four Holes Acceptable Punch Paper Weight: 52 to 220 gsm Acceptable Punch Paper Size: Four holes A3, A4, A4R, A5, B4, B5, B5R Power Source: From the Main Unit</p>
<p><b>INNER FINISHER-J1 (Internal)</b></p>	<p>Number of Trays: 2 Upper Tray Capacity*: A3, A4, A4R, A5, A5R, A6R, B4, B5, B5R: 45 sheets Lower Tray Capacity*: A4, A5, A5R, B5: 500 sheets, A3, A4R, B4, B5R 250 sheets, A6R: 30 sheets *with 81.4 gsm paper Paper Weight: 52 to 220 gsm Staple Position: Corner, Double Staple Capacity: Corner and Double Stapling: A4/B5: 50 sheets (52 to 90 gsm) A3/A4R/B4: 30 sheets (52 to 90 gsm) Eco Staple: A3/A4/B4/B5: 5 sheets (52 to 64 gsm) 4 sheets (65 to 81.4 gsm) 3 sheets (81.5 to 105 gsm) Staple On Demand: 40 sheets (80 gsm) Dimensions (W x D x H): 604 x 535 x 205 mm (when the extension tray is extended) Weight: Approx. 7.3 kg</p>	<p><b>OTHER OPTIONS</b> <b>STAPLE CARTRIDGE</b></p>	<p>STAPLE-P1 - For stapling (2 x 5,000 pcs) STAPLE CARTRIDGE-Y1 - For saddle stitching (2 x 2,000 pcs)</p>

For a complete list of all Hardware accessories, please refer to our website specifications page or online product configurator

## Software & Solutions



## Certifications and compatibility



**Canon Ireland**  
3006 Lake Drive  
Citywest, Saggart  
Co. Dublin, Ireland  
Telephone No: 01 2052400  
2052400  
Facsimile No: 01 2052525  
canon.ie

**Canon (UK) Ltd**  
Woodhatch  
Reigate  
Surrey RH2 8BF  
Telephone No: 01737 220000  
220000  
Facsimile No: 01737 220022  
canon.co.uk

**Canon Inc.**  
canon.com  
**Canon Europe**  
canon-europe.com  
English edition  
© Canon Europa N.V., 2019